

# Plusrite®

## CATALOG NUMBER: BAPS575-HX/V4

### 575W

### Pulse Start Metal Halide Lamp Ballast

### 60 Hz HX-HPF

#### 4X4 CORE - HX, CWA CWI UNITS

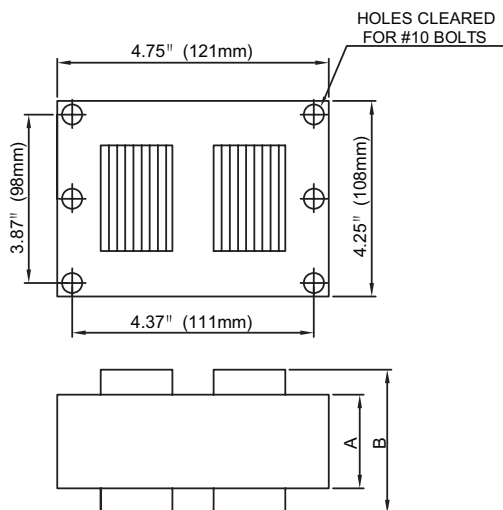

#### Capacitor:

Microfarads: 38.0 uf  
 Volts (Max): 540 V  
 Case Temp(Max): 100°C  
 D: 2.17 in  
 L: 4.33 in  
 A: 0.79 in

#### Ignitor:

Case Temp (Max): 105 °C  
 BTL Distance (Max): 2 ft

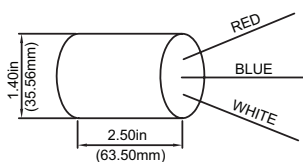
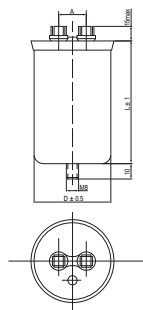

#### Wiring Diagram:

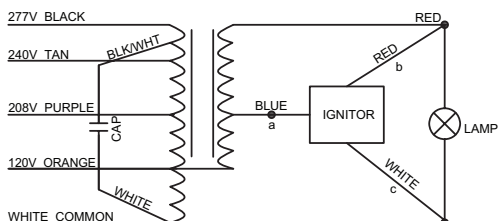

Input Volts		120	208	240	277
Circuit Type	HX-HPF				
REGULATION					
Line Volts	±5%				
Lamp Watts	±10%				
LINE CURRENT( Amps )					
Operating		5.70	3.05	2.95	2.50
Open Circuit		8.75	4.70	4.45	3.80
Starting		7.80	4.20	4.05	3.20
RECOMMENDED FUSE (Amps)					
		15	8	8	7
TEMPERATURE RATINGS					
Insulation Class	H				
Coil Temperature Code		B	A	C	C
Benchtop Coil Rise		79.3	73.9	81.6	81.3
Power Factor (Min)	90%				
Input Watts	635 W				
Efficiency					
NOM. OPEN CIRCUIT VOLTAGE	300				
INPUT VOLTAGE AT LAMP DROPOUT		90	160	180	210
MIN AMBIENT STARTING TEMP	-40°F/-40°C				
60 HZ TEST PROCEDURES					
High Potential Test (Volts)					
1 Minute	2,000 V				
1 Second	2,500 V				
Open Circuit Voltage Test (V)	270 - 330				
Short Circuit Current Test (A)					
Secondary Current					
Min	5.65				
Max	6.95				
Input Current					
Min	6.05	3.10	3.15	2.65	
Max	9.15	4.70	4.75	4.05	
CORE and COIL Specifications					
Dimension A (in)	3.25				
Dimension B (in)	4.90				
Weight (lbs)	18.0				
Lead Lengths (in)	12				
CAPACITOR REQUIREMENT					
Microfarads	38.0uf				
Volts (Min)	330 V				

Data is based upon tests performed by Plusrite in a controlled environment and is representative of relative performance. Actual performance can vary depending on operating conditions. Specifications are subject to change without notice.

Coil material: Cu/Al